



True North

VACATION HOMES

*Escape The Ordinary*

A Project by



# TRUE NORTH

## DUNGA GALI

Brought to you by



GDA APPROVED





# DUNGA GALI

PIPELINE TRACK

GLORIA JEANS

MUSHKPURI TRACK

HOTEL AMORE



TRUE NORTH



# AMENITIES



HOTEL  
SERVICES



CONFERENCE  
HALL

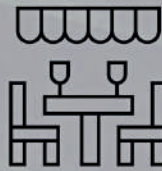

FINE DINING



ELEVATOR



CAFE



PARKING LOT



FOREST VIEW



FULLY  
FURNISHED



CHILDREN  
PLAY AREA



OPEN AIR  
GYM



BACKUP  
GENERATOR



MEDICAL  
FACILITIES



# FLOOR PLAN





# PRESIDENT SUITE

Bed 15'4" x 12'3"

Bath 8'0" x 6'0"

Balcony 18'x5"+15'x3"

Kitchen 8'0" x 5'0"





# EXECUTIVE SUITE

Bed 15'4" x 10'6"

Bath 6'6" x 6'6"

Balcony 15'4" x 5'

Kitchen 8' x 6'6"





# PREMIUM SUITE

Bed 15'4" x 12'3"

Bath 8'0" x 6'0"

Balcony 15' x 3'0"

Kitchen 8'0" x 5'0"

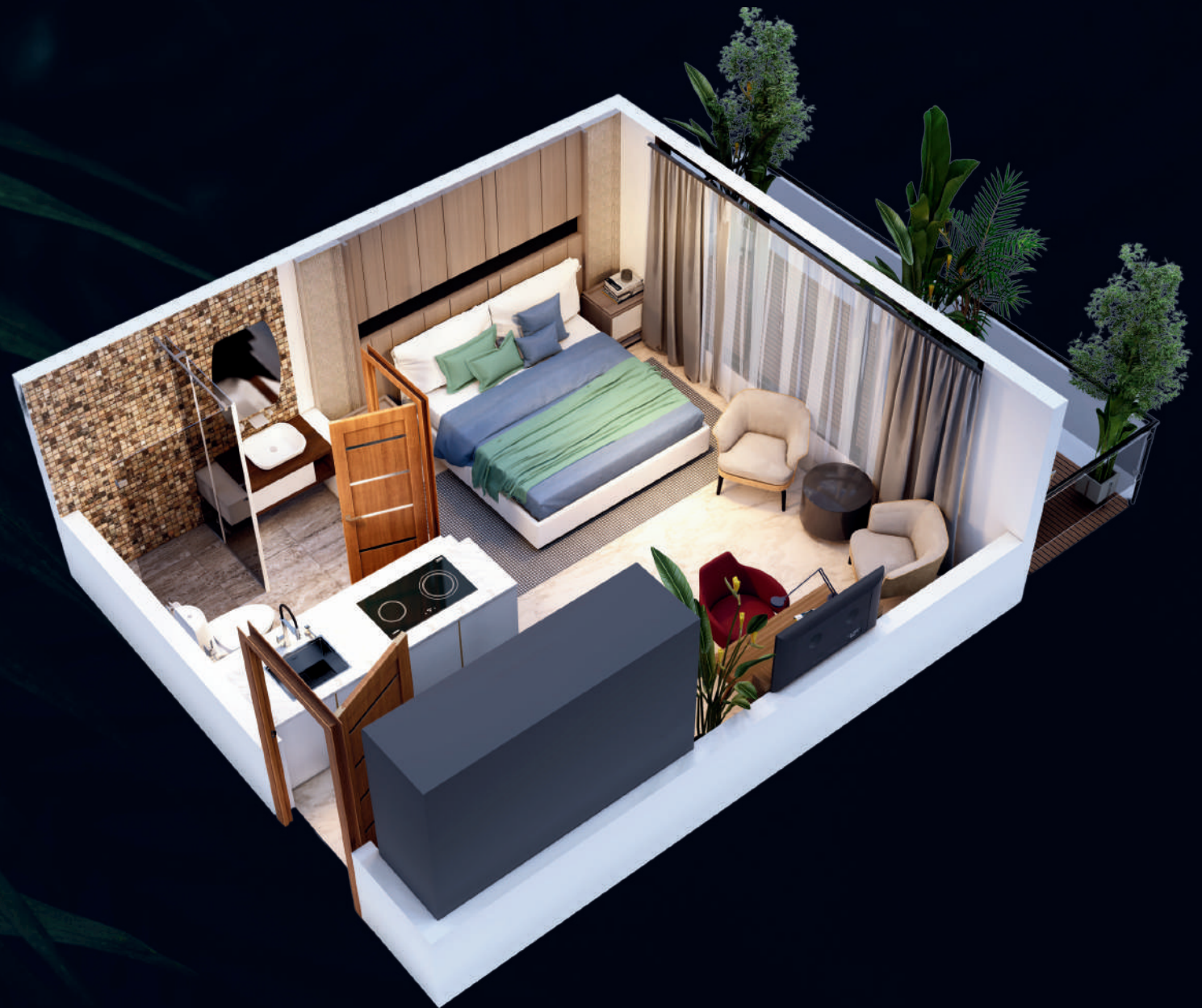



# ECONOMY SUITE

Bed 15'4" x 10'6"

Bath 6'6" x 6'6"

Kitchen 8'0" x 6'6"





# PAYMENT PLAN

## President Suite

Total price : 19,500,000

Down Payment : 6,000,000

## Premium Suite

Total price : 13,500,000

Down Payment : 4,500,000

## Executive Suite

Total price : 16,500,000

Down Payment : 5,000,000

## Economy Suite

Total price : 9,900,000

Down Payment : 3,000,000





True North

VACATION HOMES

## CAPITAL APPRECIATION

Ideal location, unrivaled panoramic views, and world-class amenities give us the confidence to expect about 40% to 60% capital gain on your investment in True North in next three Years with 15% to 20% ROI Per Annum, InshAllah.





**BLACK SWAN**  
I N V E S T M E N T



**BIN WAZIR**  
Group of companies

## **HEAD OFFICE**

Opp Saeed Book Bank.F7 Markaz, Islamabad

## **SITE OFFICE**

Main Dunga Gali Bazar

## **FOR DETAILS**

033 222222 18 / 051-2748899